

Grooved End Fittings

Series-90



Feature

- Designed to provide minimum pressure drop and uniform strength

Material

- Ductile iron body with rust inhibiting paint

Specification

- Maximum operating pressure: **500 PSI** at ambient temperature **70°F (21°C)**

Approvals

- Underwriters Listed and Factory Mutual approved

Comparable to

- Victaulic's #10
- Grinnell's #7050

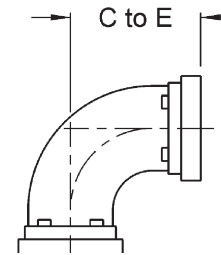

Nominal Size	Dimensions C to E	Ductile Iron Part #
2"	3-1/4"	L502
2-1/2"	3-3/4"	L5025
3"	4-1/4"	L503
4"	5"	L504
6"	6-1/2"	L506
8"	7-3/4"	L508

Series-T



Feature

- Designed to provide minimum pressure drop and uniform strength

Material

- Ductile iron body with rust inhibiting paint

Specification

- Maximum operating pressure: **500 PSI** at ambient temperature **70°F (21°C)**

Approvals

- Underwriters Listed and Factory Mutual approved

Comparable to

- Victaulic's #20
- Grinnell's #7060

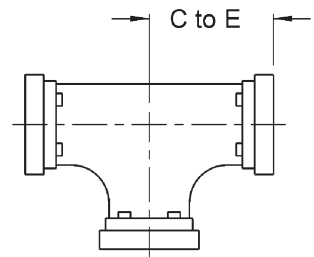

Nominal Size	Dimensions C to E	Ductile Iron Part #
2"	3-1/4"	T602
2-1/2"	3-3/4"	T6025
3"	4-1/4"	T603
4"	5"	T604
6"	6-1/2"	T606
8"	7-3/4"	T608